

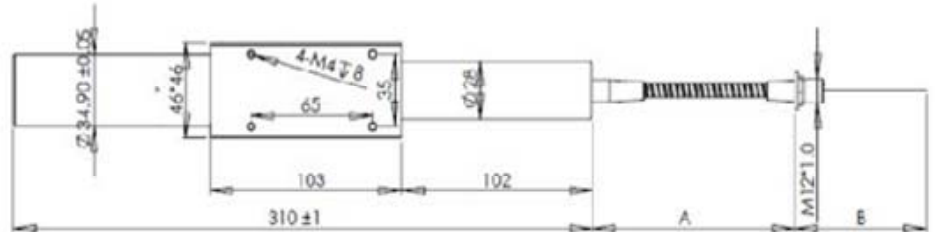

1064nm High Power Collimated Free-space Beam Output Isolator - 50W

The High Power Isolator series products include high power isolator and high power collimator. The high power isolator series includes in-line type, beam expanded isolator, fiber in and free space out isolator and free space isolator etc. 1064nm High Power Collimated Free-space Beam Output Isolator is one of the fiber in and free space out isolator. They're characterized with low insertion loss, high isolation, high power handling, high return loss, excellent environmental stability and reliability. They are ideal for fiber laser and instrumentation applications.



Features

- ◆ High isolation
- ◆ Low insertion loss
- ◆ Excellent environmental stability and reliability

Applications

- ◆ Fiber Laser

Performance Specifications

Parameters	Values
Central Wavelength(nm)	1064
Operating Wavelength Range(nm)	±10
Typ. Peak Isolation(dB)	35
Min. Isolation in Band (at 25°C) (dB)	30
Min. Transmission (%)	90
Nominal Output Beam Diameter(mm)	8±1
Min. Return Loss(Db)	50
Max. Optical Power (CW)(W)	30,50 or Specify
Max. Peak Power(kW)	30, 50
Fiber Type	LMA-GDF-20/125, LMA-GDF-25/250,20/400 DC Fiber or Specify
Fiber Length(m)	>2.5 or Specify
Armored Length(m)	2.0 or Specify
Tensile Load(kg)	1
Operation Temperature(°C)	0 ~ +50
Storage Temperature Range(°C)	-20 ~ +75

*Specifications may change without notice.

**Other specifications can be made on customer request.

Order information

HPCFSI-①①-②②-③③-④④-⑤⑤-⑥⑥

①①	②②	③③	④④	⑤⑤	⑥⑥
wavelength	Optical Power	Package Dimensions	Fiber Jacket on Input & Length	Output Beam Diameter	Fiber Length
64:1064nm XX:Other	30:30W 50:50W XX:Other	C: Circle Type Q:Quadrate Type	C25:3mm Loose Cable&2.5m Length A25:3mm Armoured Cable&2.5m Length B25:6mm Armoured Cable&2.5m Length XXX: Others	08:8mm XX:Others	30:3.0m XX:Other