

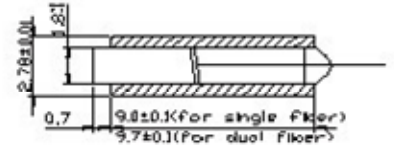

1064nm Fiber Collimator

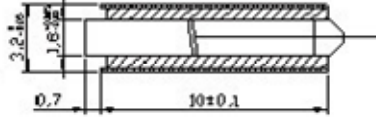

Lens
OD1.8mm



Lens
OD1.0mm

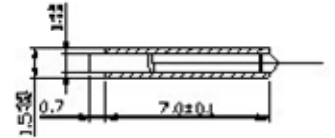
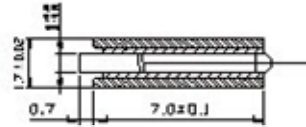

Metal Holder

Glass Tube

Features

- ◆ High power handling
- ◆ Low Insertion loss
- ◆ Cost Effective

Applications

- ◆ Fiber Laser

Performance Specifications

| Parameters | Values |
|---------------------------------------|--------------------------------------|
| Central Wavelength(nm) | 1064 |
| Operating Wavelength Range(nm) | ±30 |
| Working Distance(mm) | 5 or Specify |
| Typ. Insertion Loss(at 5mm) (dB) | 0.30 |
| Max. Insertion Loss (at 5mm) (dB) | 0.40 |
| Max. Polarization Dependent Loss (dB) | 0.02 |
| Min. Return Loss(dB) | 55 |
| Max. Optical Power (W) | 0.5, 3, 5, 10, 20 |
| Max. Peak Power (kW) | 0.5, 1, 5, 10, 20 |
| Fiber Type | HI1060,10/125,20125 fiber or Specify |
| Tensile Load(N) | 5 |
| Operation Temperature(°C) | -5 ~ +65 |
| Storage Temperature Range(°C) | -20 ~ +75 |

*Specifications may change without notice.

**Other specifications can be made on customer request.

Order information

C-①①-②-③③-④④-⑤-⑥-⑦-⑧⑧-⑨⑨

| ①① | ② | ③③ | ④④ | ⑤ | ⑥ | ⑦ | ⑧⑧ | ⑨⑨ |
|------------------------|--|-------------------|----------------------------------|-----------------------|---|---------------------------------|---------------------|---------------------|
| wavelength | Pigtail Type | Working Distance | Lens Diameter | Lens Type | Fiber Diameter | Dimension | Connector Type | Fiber Length |
| 06:1064nm XX:Others | S:Single fiber D: Dual fiber (only for 0.5W) | 05:5mm 35:35mm | 10:1.0mm 18:1.8mm XX:Other | C:C Lens G: G Lens | B:250um L:900um loose tube B:900um tight buffer fiber X:Others | M: Metal Holder G:Glass tube | 00:None XX:Other | 10:1.0m XX:Other |