

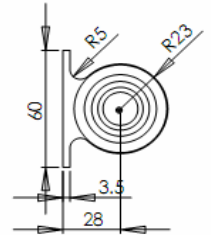

1053/1080nm High Power Polarization Independent Isolator - 20~50W

The High Power Isolator series products include high power isolator and high power collimator. The high power isolator series includes in-line type, beam expanded isolator, fiber in and free space out isolator and free space isolator etc. High Power Polarization Independent Isolator is one of the in-line type. they're characterized with low insertion loss, high isolation, high power handling, high return loss, excellent environmental stability and reliability. They are ideal for fiber laser and instrumentation applications.

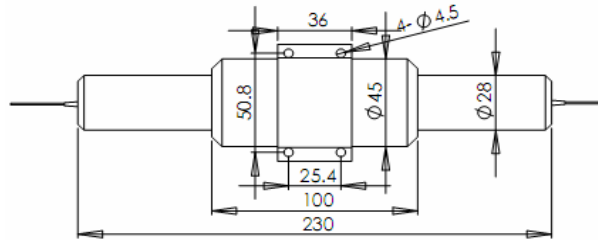

Features

- ◆ High isolation
- ◆ Low insertion loss
- ◆ Excellent environmental stability and reliability

Applications

- ◆ Fiber Laser
- ◆ Free space communications
- ◆ Research

Performance Specifications

Parameters	Values
Central Wavelength(nm)	1053/1080
Operating Wavelength Range(nm)	±10
Typ. Peak Isolation(dB)	35
Min. Isolation in Band (at 25°C) (dB)	25
Typ. Insertion Loss (dB)	0.80
Max. Insertion Loss (at 25°C) (dB)	1.20
Max. Polarization Dependent Loss (dB)	0.2
Min. Return Loss(dB)	50
Max. Peak P1wer(kW)	20,50
Optical Power (CW)(W)	20,30,50
Fiber Type	20/400 DC Fiber or Specify
Tensile Load(N)	5
Operation Temperature(°C)	0 ~ +50
Storage Temperature Range(°C)	-20 ~ +75

*Specifications may change without notice.

**Other specifications can be made on customer request.

Order information

HPPII-①①-②②-③③-④④-⑤⑤-⑥⑥

①①	②②	③③	④④	⑤⑤	⑥⑥
wavelength	Optical Power	Package Dimensions	Fiber Jacket on Input & Output	Connector Type on in &out	Fiber Length
53: 1053nm 80:1080nm XX: Other	20:20W 30:30W 50:50W XX:Other	C:Circle Type Q:Quadrate Type	09:900um Loose Fiber 3L:3mm Loose Cable 3A:3mm Armoured Cable XXX: Others	00:None XX: Others	10:1m XX: Other